

ADDENDUM 1
LANDING, STAIR & SIDING REPAIRS
RICHLAND MIGRANT CENTER
479 BERNARD AVE.
YUBA CITY, CA 95991

1. How much new concrete do we add to the existing landings at the front of the buildings?

Do to the extended railings at the bottom of the stairs the concrete sidewalks will need to be extended. Due to varying site conditions please see the drawing attached to this addendum for new concrete locations. The cross hatched areas are the locations of the new concrete.

2. To flash the wall to the upper landing do you want the siding removed and reinstalled at those walls?

A minimum of 48" of siding adjacent to the door, as measured from the corner out to the next factory edge, above and below the landing shall be removed for inspection of the framing for possible water damage. The siding shall be replaced with a matching product (Hardi Panel) and painted to match.

3. Due to the delay in getting the responses to these RFI's posted the bid opening date will be extended. The new bid opening date and time is August 20, 2018 at 10:00am.

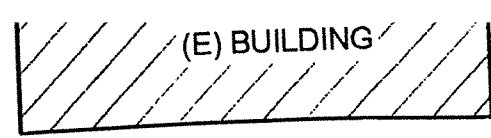
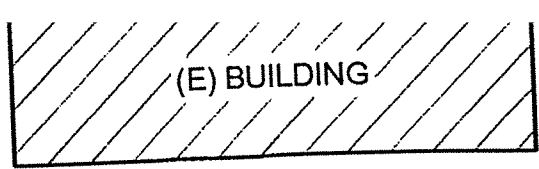
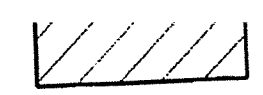
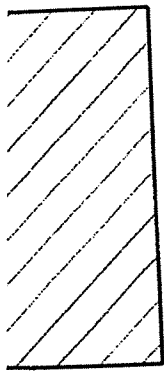
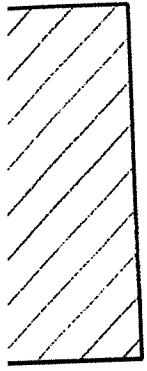
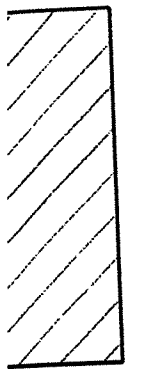

(E) BUILDING

(E) BUILDING

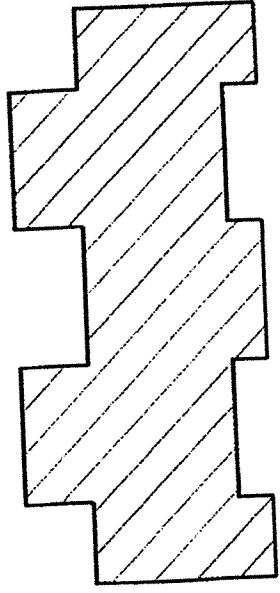

BUILDING 'E'

A9

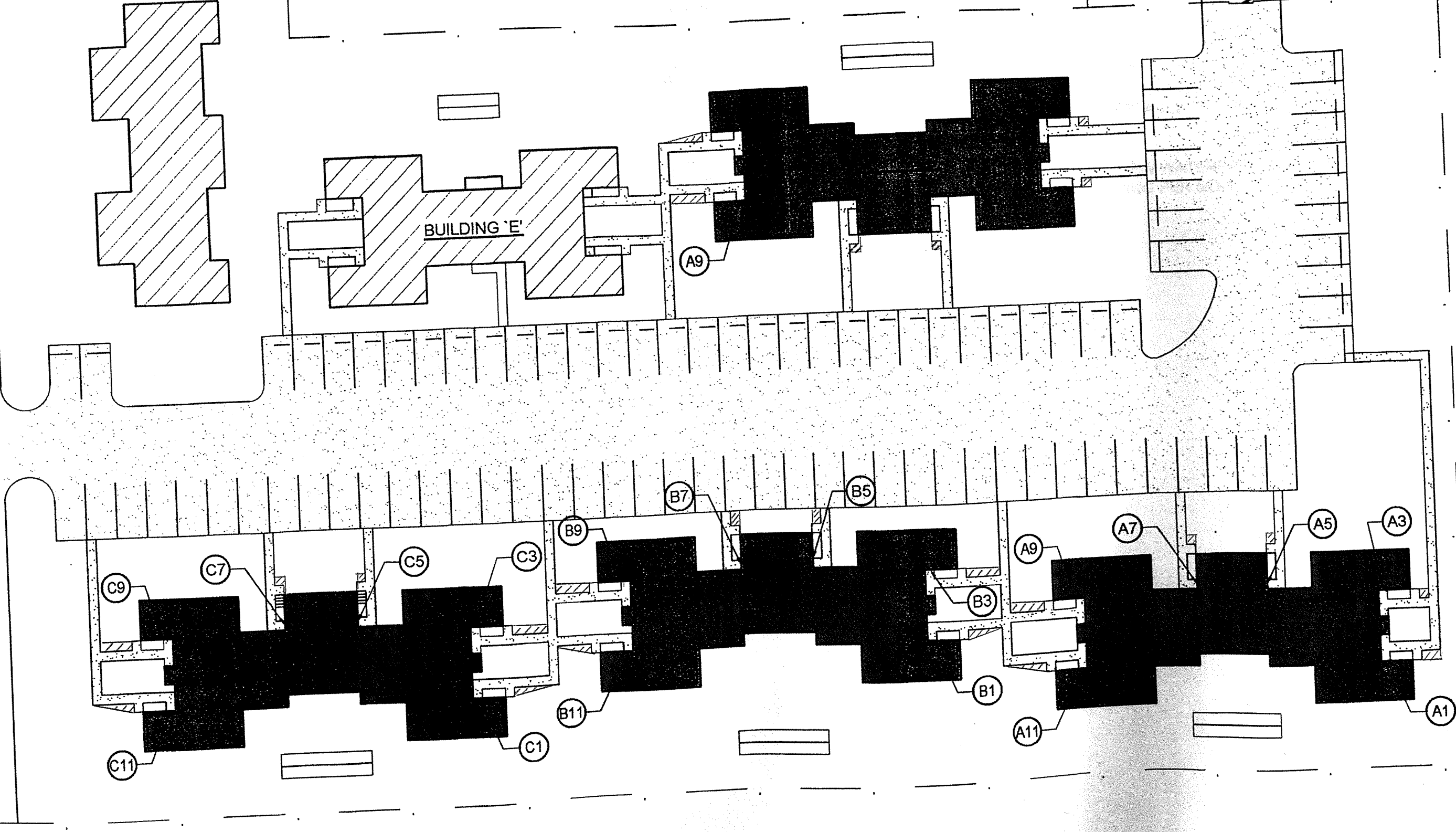

C11

C1

B11

A11

A1